

# User Manual

## Solar Powered Motion Sensor Light

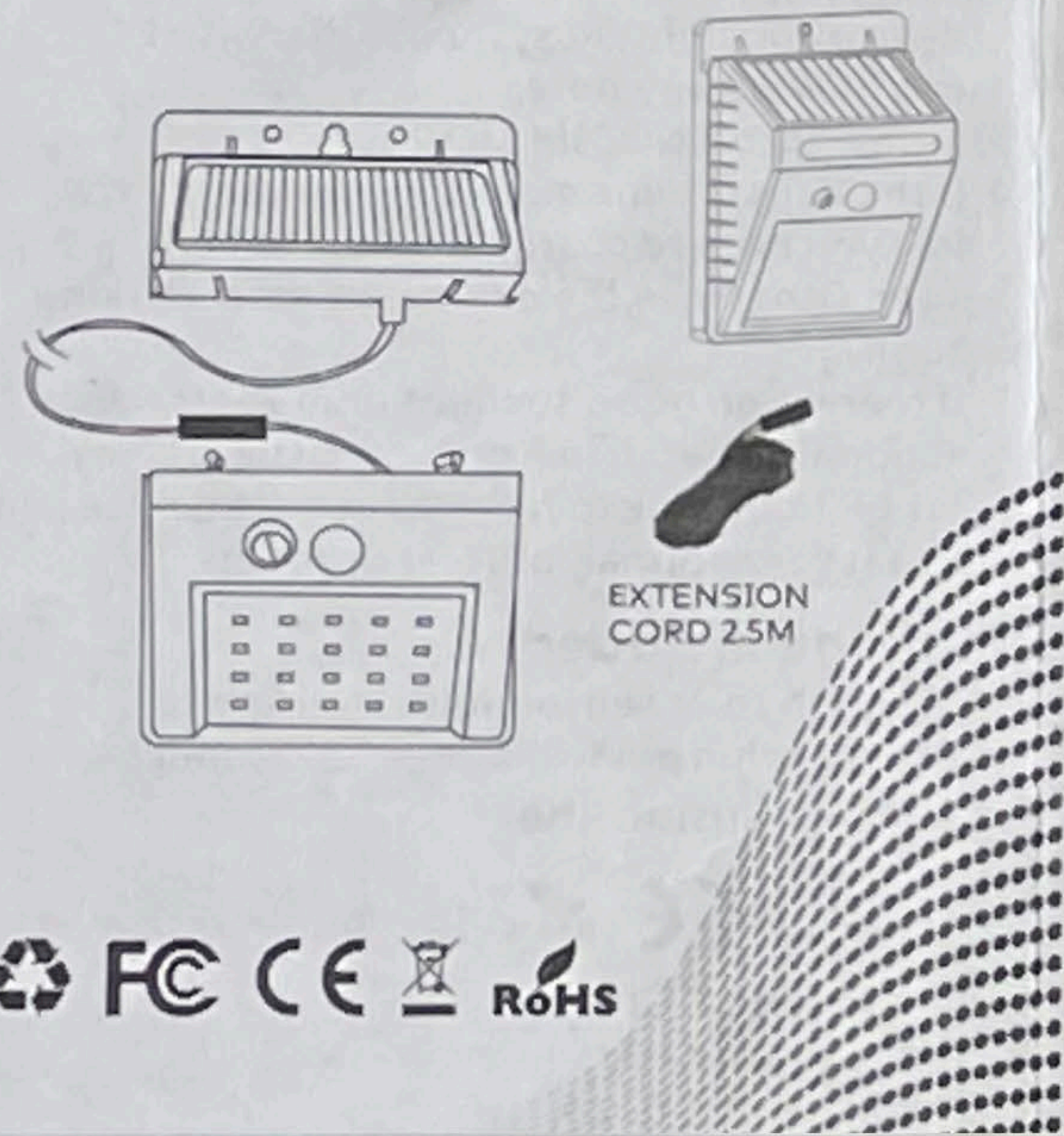

### Important:

To use it for the first time, please press the switch to turn on the product, then charge the product by placing it under direct sunshine for 4 to 5 hours (avoid the shadow caused by trees or buildings etc). then the light can work normally. (tips: because the battery may drain out during the transportation process, please charge the battery before use it for the first time.)

### Warning:

1. Keep the device away from fire, and moist places in order to avoid explosion, leakage, moisture. (Weatherproof IP44).
2. Any severe shock to the charger is not recommended.
3. No one except professional technicians should attempt to disassemble the charger in order to avoid damaging the charger.

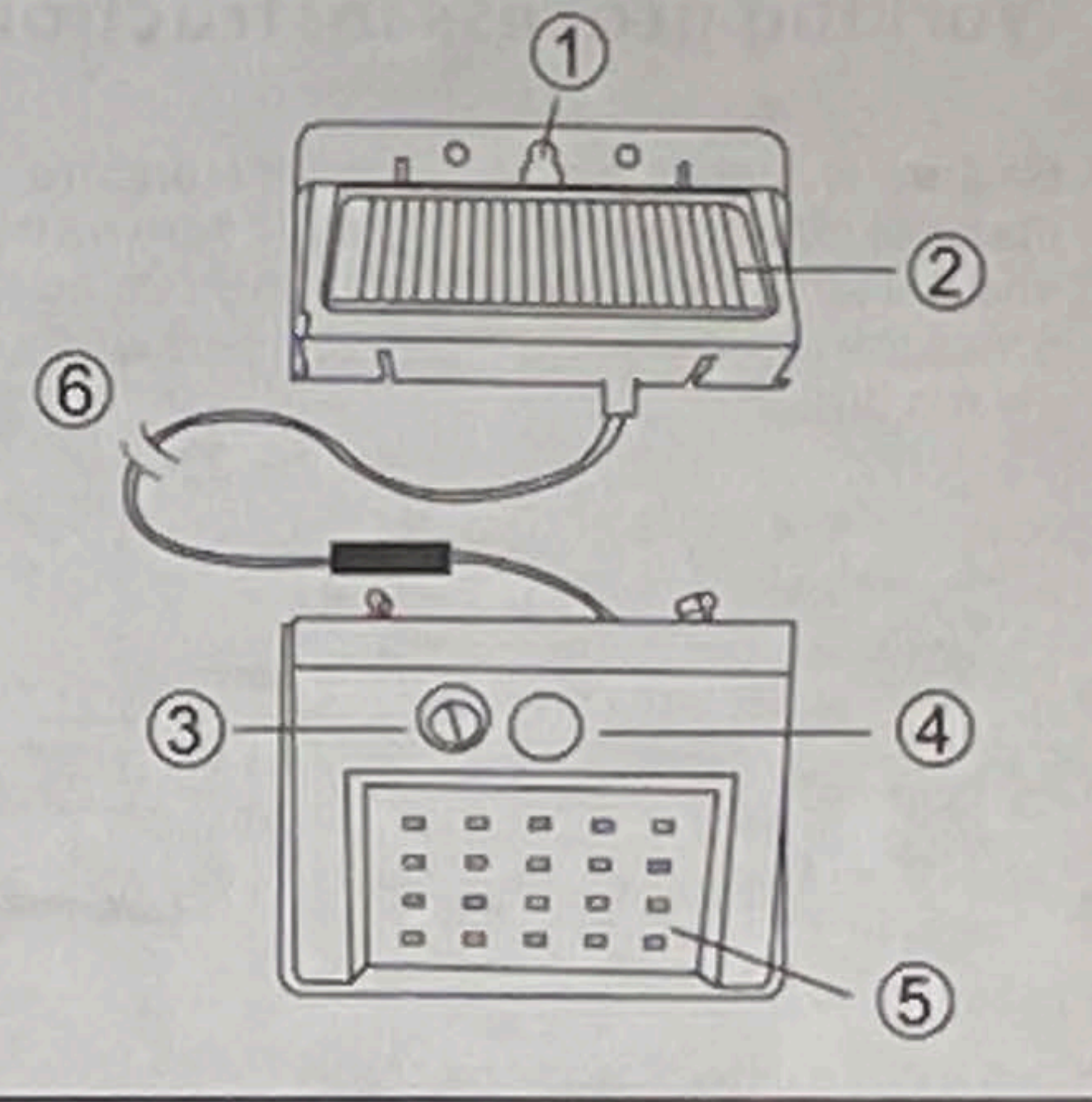

- ① Fixd Screw Hole
- ② Solar Panel
- ③ Switch ON/OFF
- ④ PIR Motion Sensor
- ⑤ LED
- ⑥ Connectig line

### Specification:

1. Solar panel: 0.55W 5.5V
2. Li-ion battery: 1200mAh, 3.7v
3. LED: 0.2W/pcs, 6500K
4. Motion angle and distance: 120° 3M
5. High light delay: 15S
6. Switch: ON/OFF
7. Lighting mode:
  - OFF
  - High light
8. Size: 124\*96\*48mm

### Product Features:

1. Recharged by sunlight and store power for overnight lighting.
2. Over 12Hours lighting time after one charge.
3. Weatherproof IP44, heatproof and durable.
4. Intelligent energy-saving.

1

2

3

### Operation Instructions:

#### 1. Unlock and activate the solar light:

The internal battery is locked from factory for safety shipment, so users have to use supplied Key pin to click the "on/off" switch hole and unlock the battery and lighting system.

#### 2. How to install the device?

Please use the supplied Expansion pillar-hinge and screws to mount the device on Pole or wall anywhere outside you want for lighting.

#### 3. Charging via solar panel:

Please install the unit face south and make sure the solar panel can get the good sunlight directly without any shelter or glass. Normally it can be fully charged in one day under ideal bright sunlight.

#### 4. Motion sensor function

It will auto tum on bright light when people walk around 2 meters close, and last 15 s, then auto tum off.

4

### Working process instructions

Be sure to install in a place exposed to direct and full sunlight, then press the ON/OFF switch button

Install standard plastic screws into wall, then using metal screws fix it

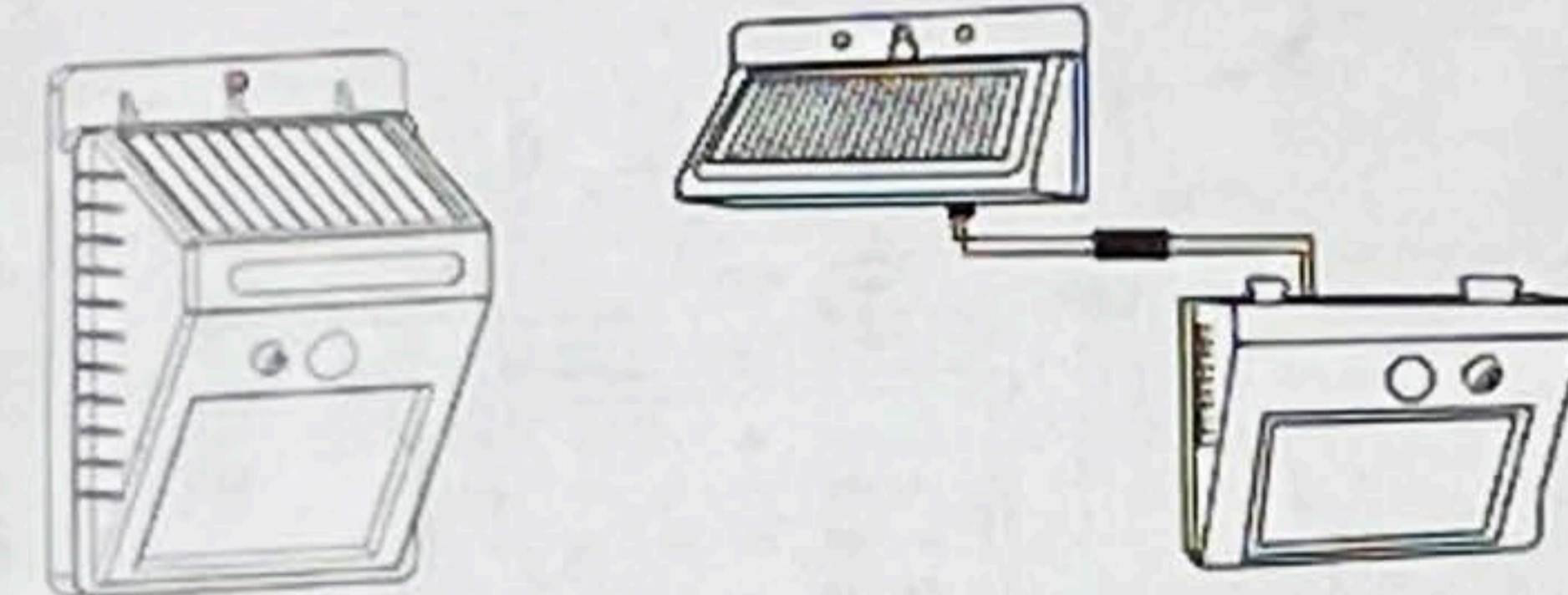

Step1: Charging under sun in day time around 7 hours

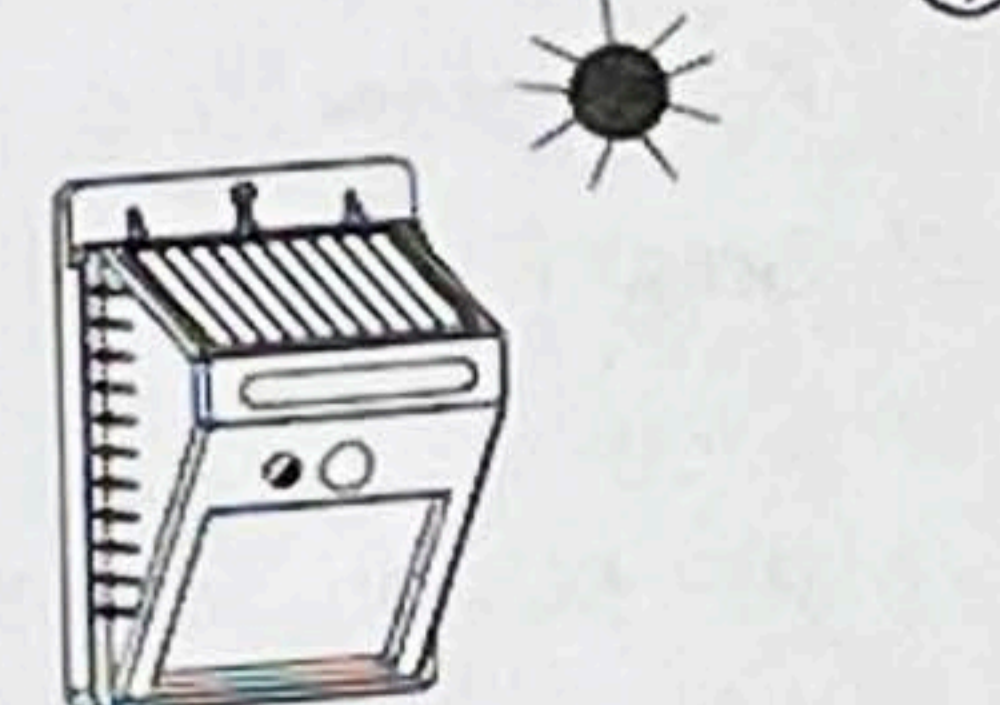

5



6

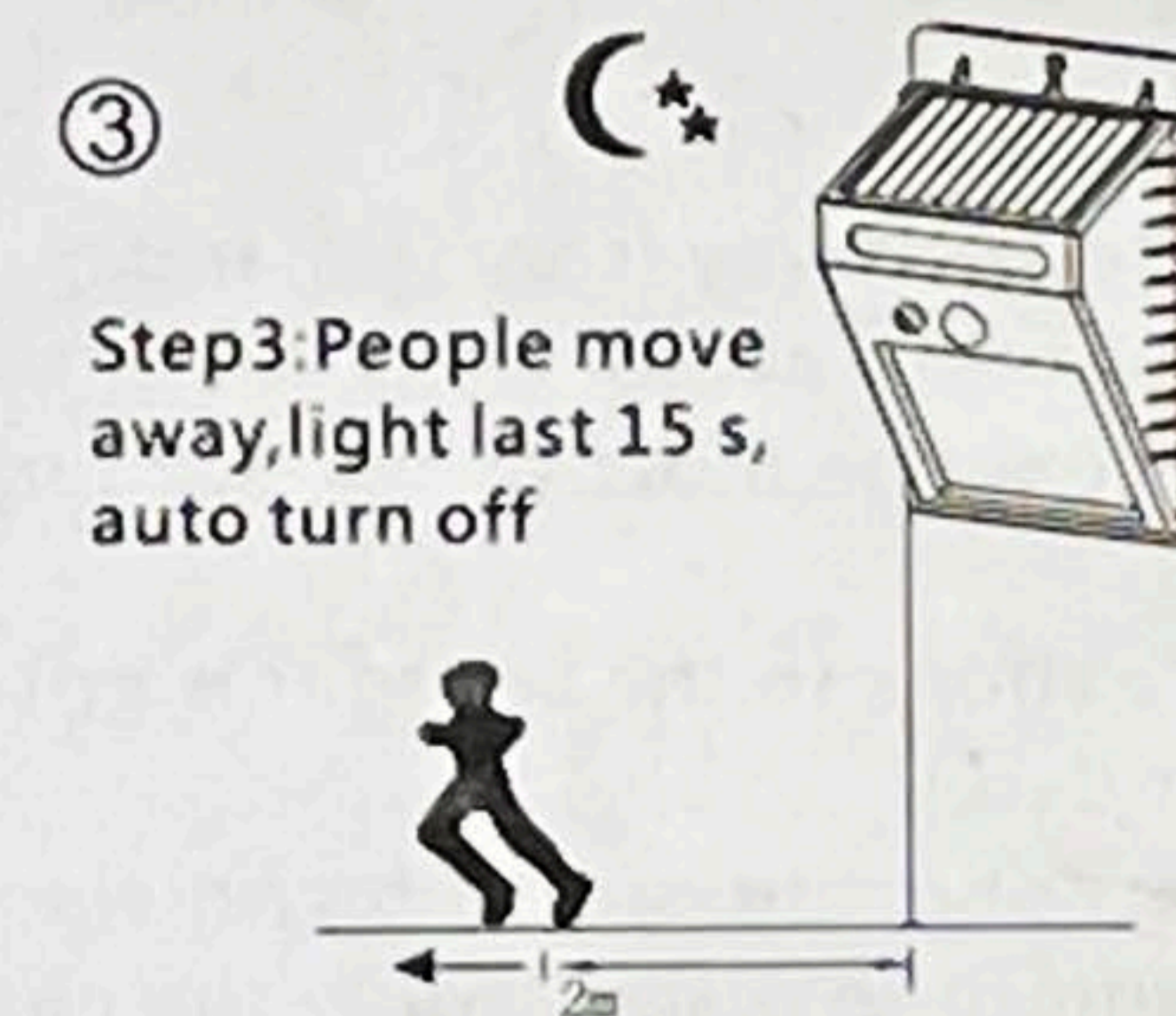

### Tips:

1. Please fully charge the device before first use.
2. If there is no good sunlight in 3 months, the battery may be out of power, so you have to charge it by bright sunlight, when it's fully charged, please use Supplied Key to unlock the device and lighting system, otherwise, it can't work anymore.
3. Mode: on/off, NODIM MODE
4. If the light is blink means the power is very low, you have to charge it by sunlight soon. Otherwise, the device will stop working soon.
5. If there is no good sunlight or in winter sunlight, especial in North countries, it may take longer time to fully charge the device and this is very normal for solar products.

### Package included:

- 1x Holan solar sensor light.
- 1x Screw
- 2x Expansion pillar-hinge.
- 2x Manual
- 2.5M extension line.



7